

سطل گیر Bucket

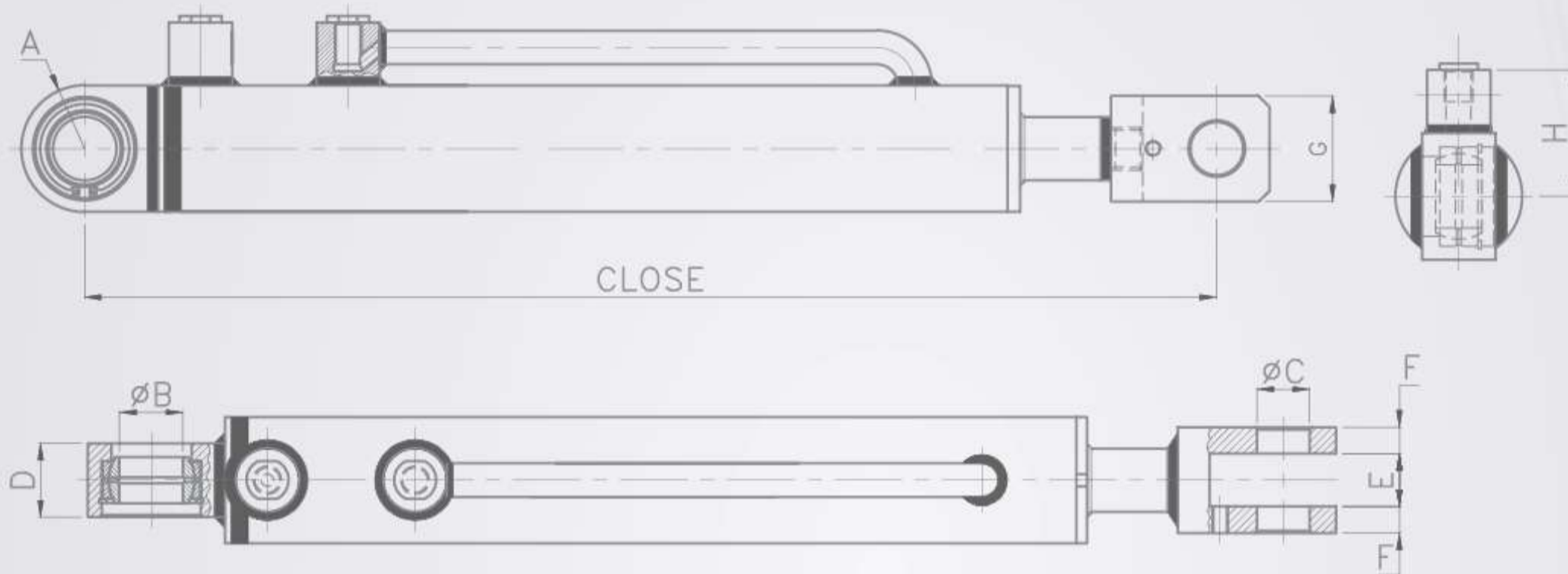

مکانیزم Mechanism

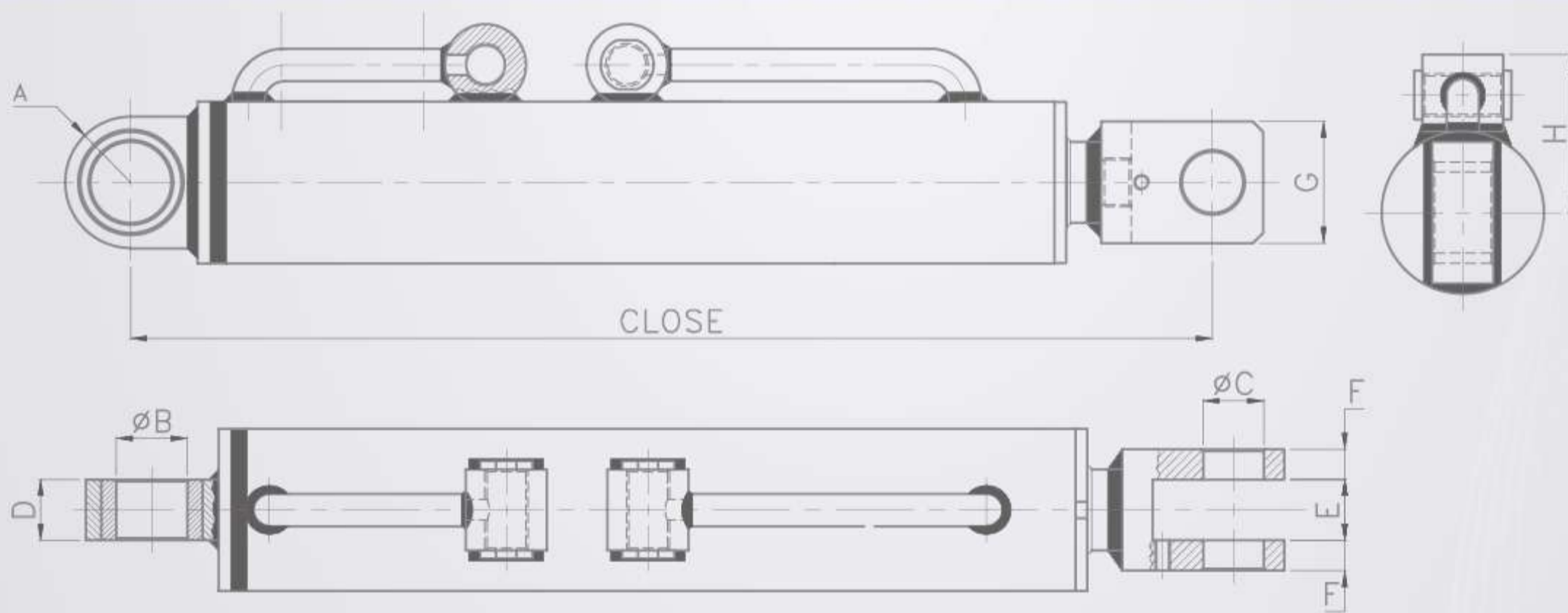

پارو Paddle

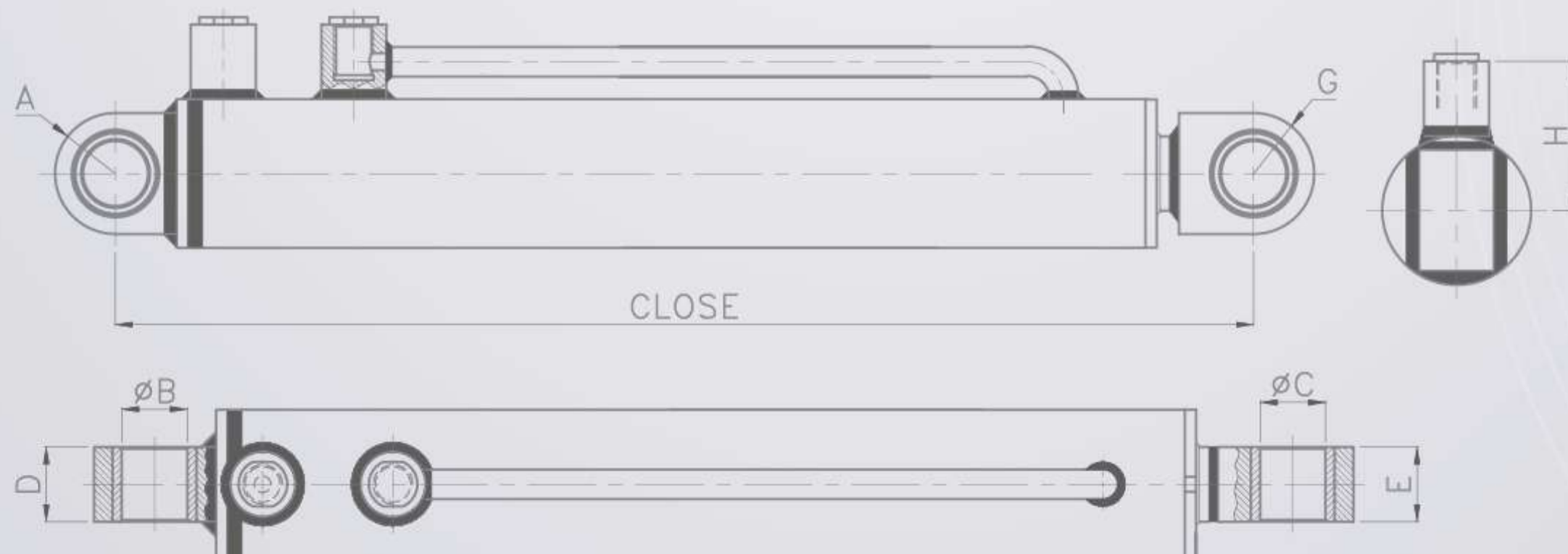

بالابر هاپر Hopper

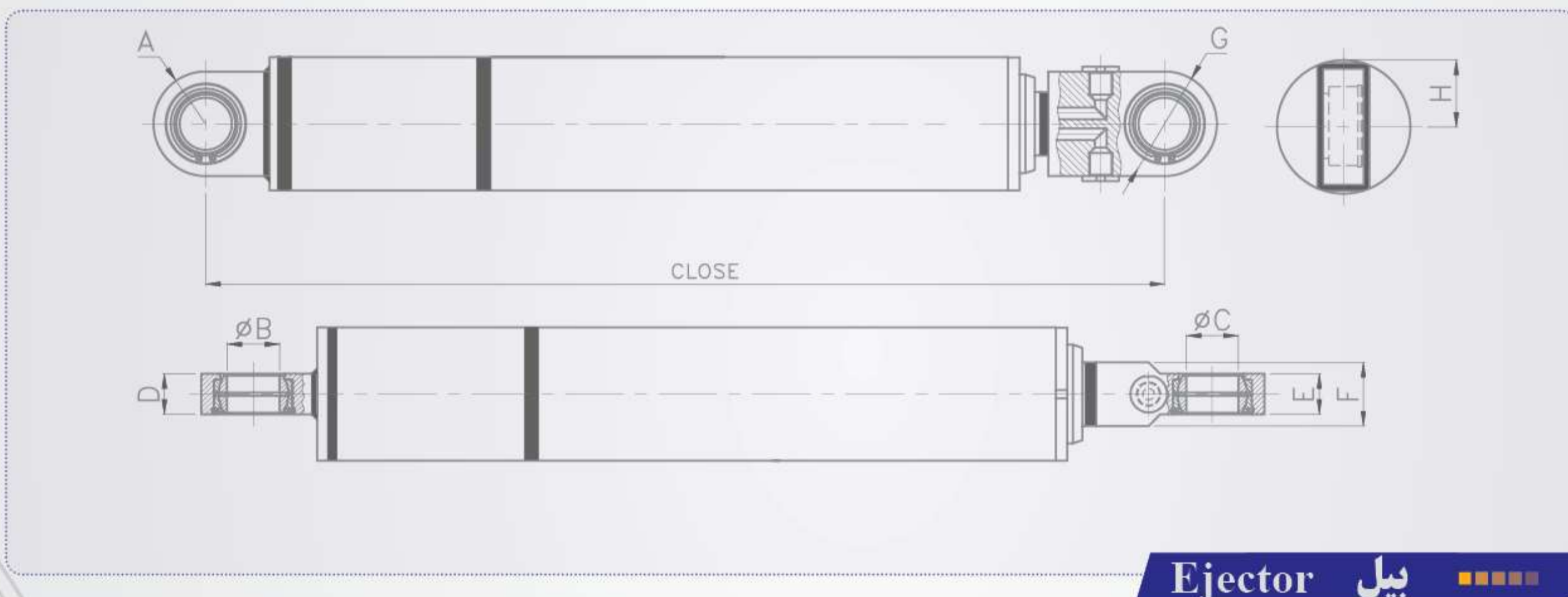
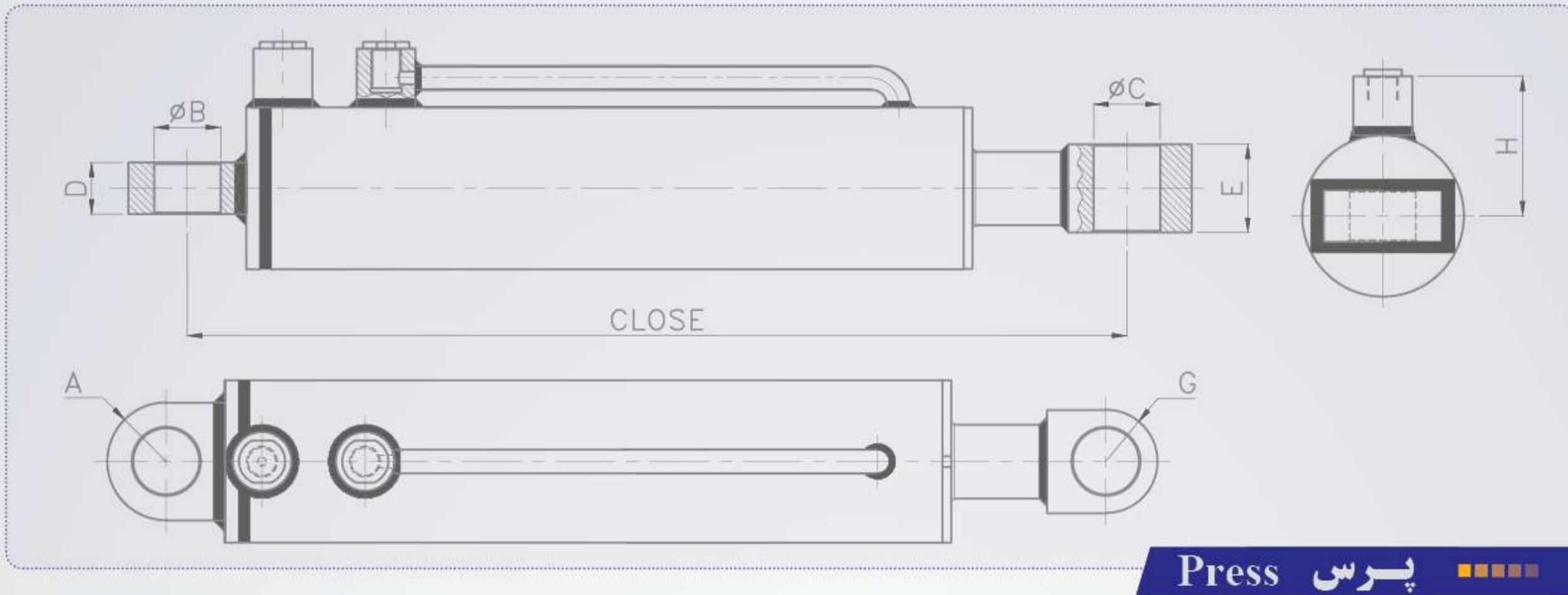

نام جک NAME	قطر سیلندر TUBE (mm)	قطر شافت ROD (mm)	کورس STROKE (mm)	بسته CLOSE (mm)	پورت PORT (BSP)	A (mm)	B (mm)	C (mm)	D (mm)	E (mm)	F (mm)	G (mm)	H (mm)
سطل گیر (BUCKET)	50-60	30	195	375	G3/8	25	20	20	25	25	-	25	60
مکانیزم (MECHANISM)	50-60	30	360	590	G3/8	30	30	25	35	25	12.5	50	60
پارو (PADDLE)	70-80	40	480	700	G1/2	32.5	35	30	30	30	15	60	78
بالابر هابر (HOPPER)	70-80	40	440	640	G1/2	32.5	35	35	40	40	-	32.5	80
پرس (PRESS)	100-110	50	625	885	G1/2	40	45	45	35	60	-	35	95
بیل (EJECTOR)	100-115 75-85	35-55	2160	1640	G1/2	45	45	45	35	35	55	45	57.5

WORK PRESURE : 130 bar
TEST PRESURE : 200 bar